

Schwerdtfeger Road 48.8 Acres available Schwerdtfeger Road

Price Temporarily Reduced \$279,000.00

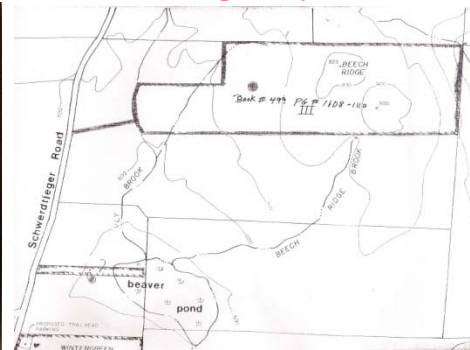
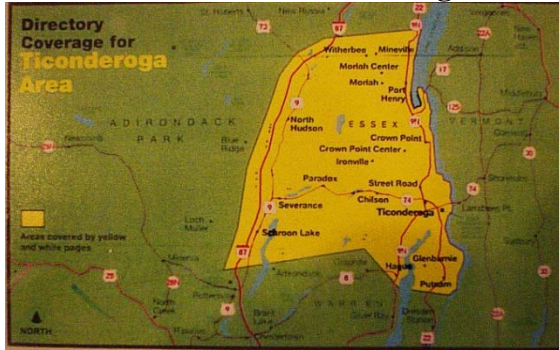

Glenburnie at Lake George Adirondack Mountains
Putnam Station, New York 12861

This private and quiet location is situated between the very historical towns of Ticonderoga with its famous Fort Ticonderoga and ferry to Vermont, and the town of Whitehall, birthplace of the United States Navy. Residents have deeded boat docking and beach rights on Lake George with spectacular views of gorgeous Lake George on one side and the grand Lake Champlain on the other. The Town also offers its residents a sandy beach in the next bay which includes a small boardwalk, boat launch docks, ball field, tennis courts, etc. as well as a great school system. Residents have easy access to many ski resorts such as Gore Mountain, Pico, Killington, Vermont, and can take advantage of the extensive outlet shopping at Lake George Village, Lake Placid, and Rutland, Vermont, home of the prestigious Middlebury College. This property is classified in Resource Management land use. Will make a sensational family compound!

TERMS AVAILABLE! DEVELOPERS & BROKERS WELCOME!

Prices and offers may change without notice at the Owner's discretion.

www.lakegeorgeatglenburnie.com www.lakegeorgenyrealestate.net
www.glenburnielakegeorge.com www.lakegeorgerealestateglenburnieny.com

glenburnieTE1@aol.com Fax: 201-573-0834
Contact us by phone: 800-867-8816